

720W LED GROW BAR

Model: LX-GLM120-12

LED GROW WORLD
www.ledgrowworld.com
1-800-380-4081

DESCRIPTION

- Full spectrum led grow light for indoor plants, vegetables and flowers.
- Performs extremely well in all stages of growth.
- Get higher yields with quality leds
- Full spectrum and color select feature
- 1m x 1m optimal coverage
- High efficiency and low heat output

FEATURES

- For Indoor Plants, Vegetables & Flowers
- Performs extremely well in cloning, vegetative and flowering cycle
- Replaces 1000w HID lamp.
- High quality Osram SMD 3030 led chips
- Use for all stages of plant growth
- Full spectrum 380-780nm
- Advanced LED Drivers for Higher Performance
- Eliminates A/C in most grow spaces due to very low heat output
- No Fan required design
- Environmentally friendly (No Mercury)
- 5 ft Power Cord
- Maximum 120° adjustable for each bar

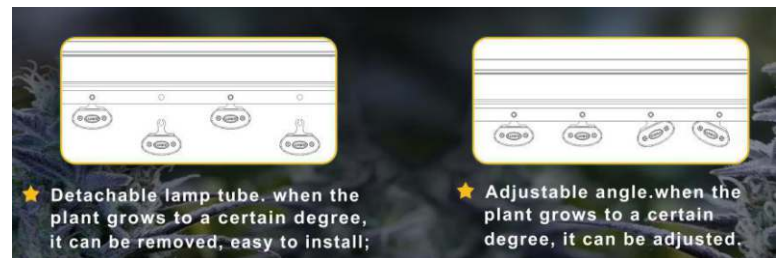

PRODUCT DIMENSION

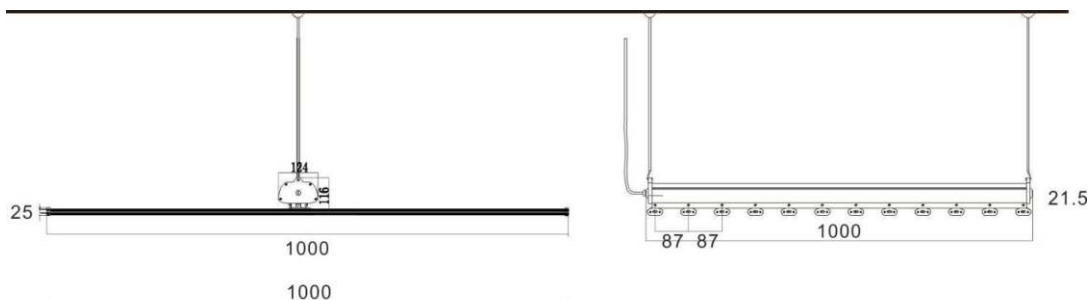

0°-120° Adjustable Beam angle

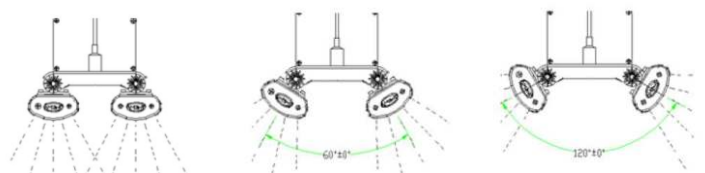

Unit:mm

SPECIFICATION

Part Number	LX-GLM120-12
LED Wattage	720W
Consumed Power	660w±10%
Input Voltage	AC 100-265V/50-60HZ
LED Chip	Osram smd 3030
PPF	1663.36umol/s
Efficacy	2.45umol/J
Spectrum	Full Spectrum
IP Rating	IP54
Working Environment	-40°C to 50°C, 15%~90%RH
Storage Environment	-40°C ~ +60°C
Power Factor	>0.9
Housing Material	ALUMINUM + PC lens +PC cover
Product Size	L 1000mm x W 1000mm x H 118 mm (39.37in x 39.37in x 4.64inch)
Mounting Height	≥ 12" (30.48cm) Above Canopy
Thermal Management	Passive
Optics	120°
Lifespan	>60000hrs - L70 @ 66.7°C
Warranty	3 Years
Certificates	ETL listed, LM-79, IES, ISTMT, TM-21
Weight	21kg (46.29lbs)

HORIZONTAL COVERAGE AREA

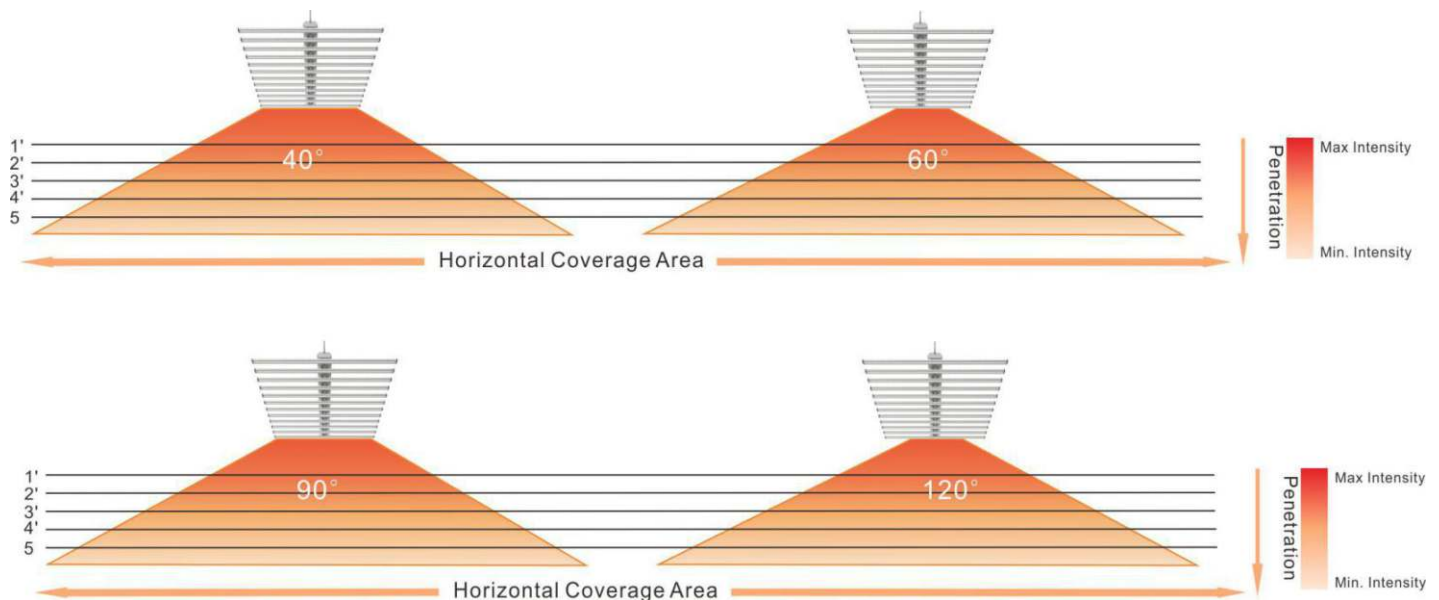

PPFD DATA

Light was positioned at 45CM height($\mu\text{mol}/\text{m}^2/\text{s}$)

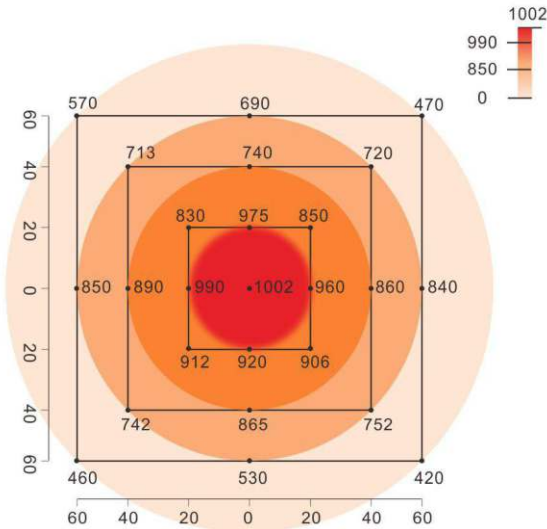

PPFD
LX-GLM120-12

	60	572	590	580	660	720	650
30CM	40	612	660	607	837	893	820
	20	990	1062	945	987	996	985
	0	897	956	1079	1158	1045	1024
90CM	60	360	378	371	370	382	352
	40	397	540	490	390	420	400
	20	690	870	680	710	850	705
	0	694	721	903	906	895	714
120CM	60	420	450	431	460	475	472
	40	480	490	460	480	490	480
	20	612	710	635	590	720	580
	0	580	690	749	750	730	680

SPECTROGRAM / PPF TEST DATA

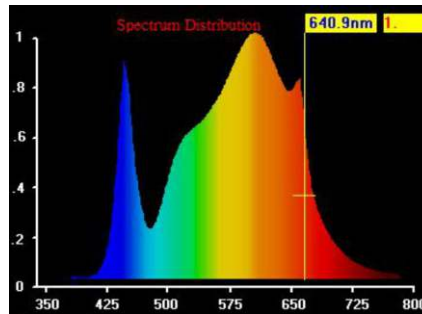

Data is for reference only

TM-21 REPORT



TM-21 Report

Table 1: Report at each LM 80 Test Condition			
Description of LED Light Source Tested (manufacturer, model, catalog number)	Manufacturer of the LED chip(s): OSRAM Opto Semiconductors (Malaysia) Sdn. Bhd. Type of LED chip(s): LH CPDP		
	Test Condition 1 - 55° C Case Temp	Test Condition 2 - 85° C Case Temp	Test Condition 3 - 105° C Case Temp
Sample size	25	Sample size	25
Number of failures	0	Number of failures	0
DUT drive current used in the test (mA)	800	DUT drive current used in the test (mA)	800
Test duration (hours)	10,000	Test duration (hours)	10,000
Test duration used for projection (hour to hour)	5,000 - 10,000	Test duration used for projection (hour to hour)	5,000 - 10,000
Tested case temperature (° C)	55	Tested case temperature (° C)	85
α	1.962E-06	α	9.514E-07
B	0.975	B	0.968
Reported L70(10k)	>60000	Reported L70(10k)	>60000

Table 2: Interpolation Report (projection based on <i>in situ</i> temperature entered)	
$T_{s,1}$ (° C)	55.00
$T_{s,1}$ (K)	328.15
α_1	1.962E-06
B_1	0.975
$T_{s,2}$ (° C)	85.00
$T_{s,2}$ (K)	358.15
α_2	9.514E-07
B_2	0.968
E_d/k_b	-2.83E+03
A	3.476E-10
B_0	0.971
$T_{s,i}$ (° C)	66.70
$T_{s,i}$ (K)	339.85
α_i	1.457E-06
Reported L70(10k) at 66.7° C (hours)	>60000

720W LED GROW BAR

Model: LX-GLM120-12

LED GROW WORLD
www.ledgrowworld.com
1-800-380-4081

ISO ILLUMINATION DATA

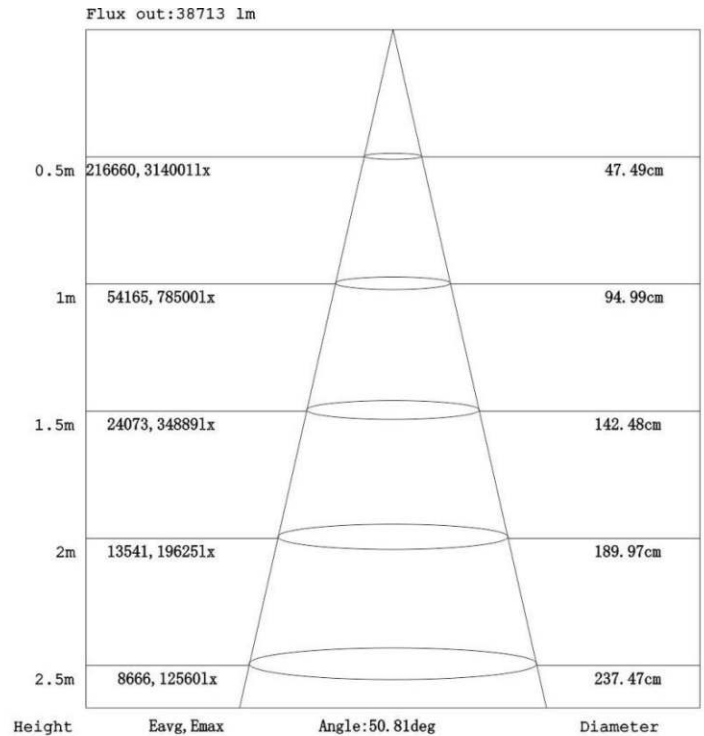
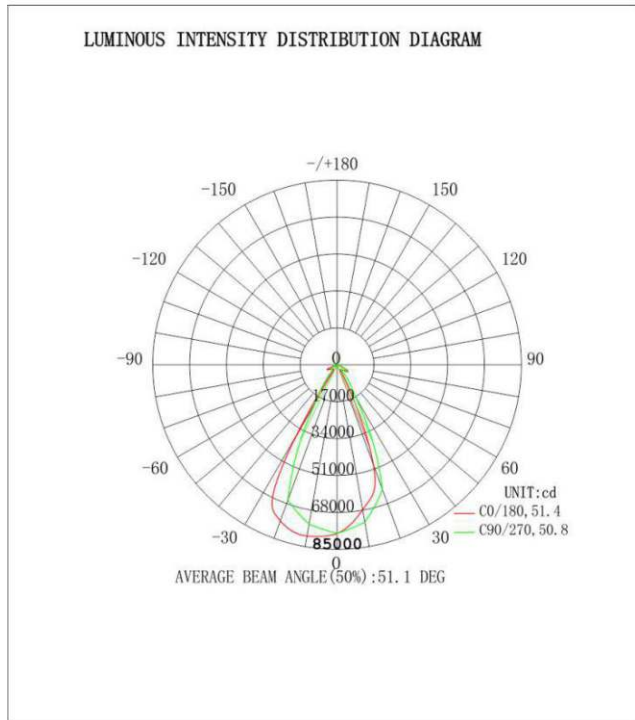
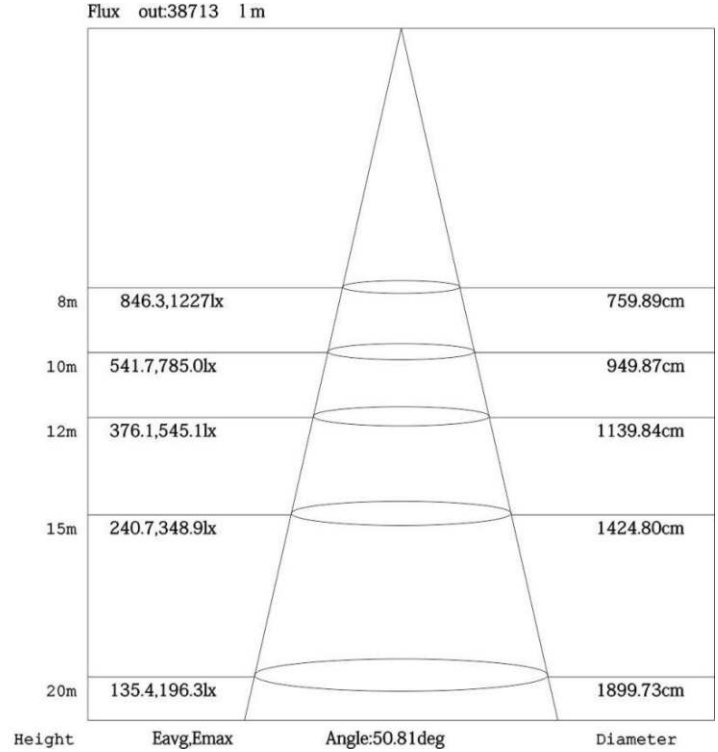
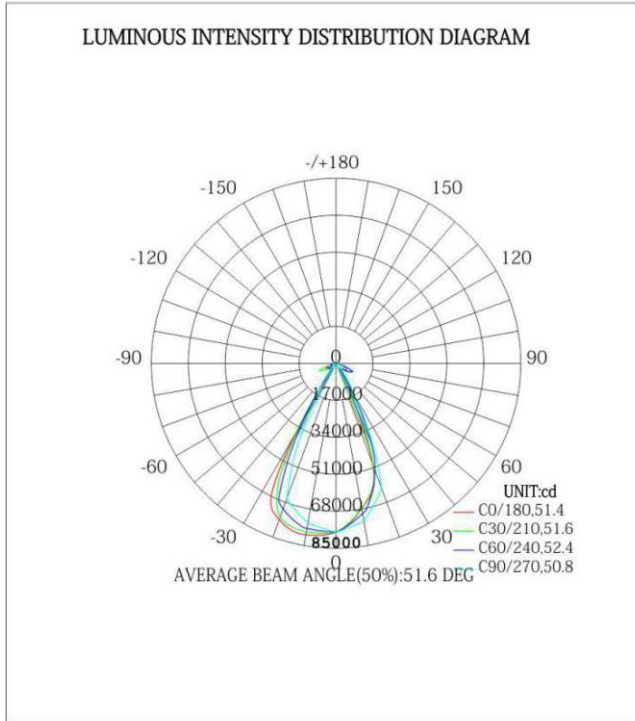

Note:The Curves indicate the illuminated area and the average illumination when the luminaire is at different distance.

WARNING

- Extremely bright, do not look directly at the LED lights
- No extra ballast is needed
- Can be controlled by Timer